



WELLHEAD
DISTRIBUTORS
INTERNATIONAL

API-6A Wellhead

Casing Heads

WDI's WC-22 casing heads feature a versatile straight bore design that can accept a wide variety of slip and mandrel type casing hangers.

Features

- Features a 45° landing shoulder capable of supporting maximum loads
- Prevents test plugs from wedging under pressure

Outlets

- Line Pipe Outlets
- Studded Side Outlets

Casing Hanger Compatibility

- WC-21 and WC-22 slip-type casing hangers
- Mandrel style casing hangers

Manufacturing Standard

- API-6A, PSL-1, DD, L-U, PR-1

Availability

- Additional sizes available upon request
- Available in WC-29 profile upon request

Lock screws

- WC-22-BP casing heads are supplied with (2) lockscrews for wear bushing retention
- WC-22-L and WC-29-L casing head are supplied with a full set of lockscrews for mandrel casing hanger and packoff retention

Bottom Connections

- Slip-on weld
- Slip-on weld with o-ring
- Threaded

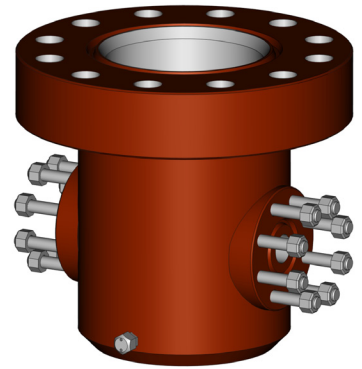



Casing Heads

Specifications

Flange Size	Working Pressure	Casing Size	A	B	C	D	Approximate Weight	P/N SOW Btm	P/N Female Threaded Btm
11"	2,000	9-5/8"	17"	10-1/8"	10-7/8"	9"	505#	01-CB012	N/A
11"	3,000	8-5/8"	17"	10-1/8"	10-7/8"	8"	535#	01-08355	01-08400
11"	3,000	9-5/8"	17"	10-1/8"	10-7/8"	9"	525#	01-00014	N/A
11"	3,000	10-3/4"	17"	10-1/8"	10-7/8"	10"	490#	01-00016	N/A
11"	5,000	8-5/8"	17"	10-1/2"	10-7/8"	8"	685#	01-15118	01-00221
**11"	5,000	9-5/8"	17"	10-1/2"	10-7/8"	9"	680#	01-15120	N/A
11"	5,000	10-3/4"	17"	10-1/2"	10-7/8"	10"	670#	01-15121	N/A
13-5/8"	3,000	13-3/8"	17"	10-1/4"	13-1/2"	12-1/2"	570#	01-08252	N/A
**13-5/8"	5,000	13-3/8"	19"	10-1/4"	13-1/2"	12-3/8"	1000#	01-08253	N/A
21-1/4"	2,000	20"	20"	10-1/4"	21-1/8"	19"	1050#	N/A	N/A
20-3/4"	3,000	20"	23"	15"	20-1/8"	19"	1322#	N/A	N/A